

ORCHARDS OF WESTLAKE - PHASE II

BEING A REPLAT OF TRACT "S", A PORTION OF OPEN SPACE TRACT #11, OPEN SPACE TRACT #12 AND WATER MANAGEMENT TRACT #9, ORCHARDS OF WESTLAKE - PHASE I, PLAT BOOK 131, PAGES 192 THROUGH 210, INCLUSIVE, OF THE PUBLIC RECORDS OF PALM BEACH COUNTY, FLORIDA, WITHIN SECTIONS 5, 6, 7 AND 8, ALL IN TOWNSHIP 43 SOUTH, RANGE 41 EAST, CITY OF WESTLAKE, PALM BEACH COUNTY, FLORIDA.

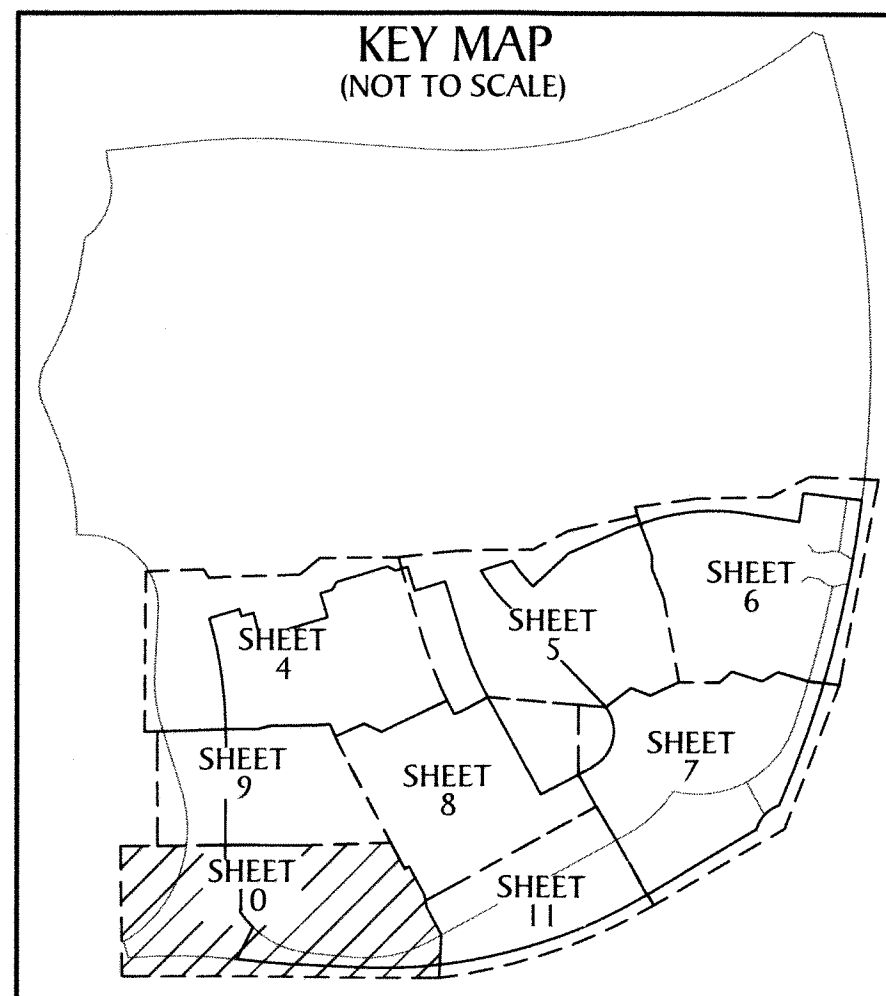

LEGEND

- | | |
|---|---|
| P.O.B. ----- POINT OF BEGINNING | CB ----- CHORD BEARING |
| P.O.C. ----- POINT OF COMMENCEMENT | C ----- CHORD |
| P.B. ----- PLAT BOOK | N.T. ----- NON-TANGENT |
| D.B. ----- DEED BOOK | N.T.C. ----- NON-TANGENT CURVATURE |
| O.R./O.R.B. ----- OFFICIAL RECORDS BOOK | P.C. ----- POINT OF CURVATURE |
| PG./PG(S) ----- PAGE(S) | P.T. ----- POINT OF TANGENCY |
| NAD ----- NORTH AMERICAN DATUM | R.I. ----- RADIAL INTERSECTION |
| W.M.T. ----- WATER MANAGEMENT TRACT | R/W ----- RIGHT-OF-WAY |
| O.S.T. ----- OPEN SPACE TRACT | (R) ----- RADIAL |
| P.B.C. ----- PALM BEACH COUNTY | (NR) ----- NON-RADIAL |
| U.E. ----- UTILITY EASEMENT | HOA ----- HOMEOWNERS ASSOCIATION |
| D.E. ----- DRAINAGE EASEMENT | S.I.D. ----- SEMINOLE IMPROVEMENT DISTRICT |
| L.M.A.E. ----- LAKE MAINTENANCE ACCESS EASEMENT | PRM ----- PERMANENT REFERENCE MONUMENT |
| 7-43-41 ----- SECTION-TOWNSHIP-RANGE | ● ----- PERMANENT CONTROL POINT |
| R ----- RADIUS | □ ----- FOUND PERMANENT REFERENCE MONUMENT |
| L ----- ARC LENGTH | ■ ----- SET 4"x4" CONCRETE MONUMENT WITH 2" ALUMINUM DISK STAMPED "PRM LB 7768" |
| D ----- DELTA ANGLE | |

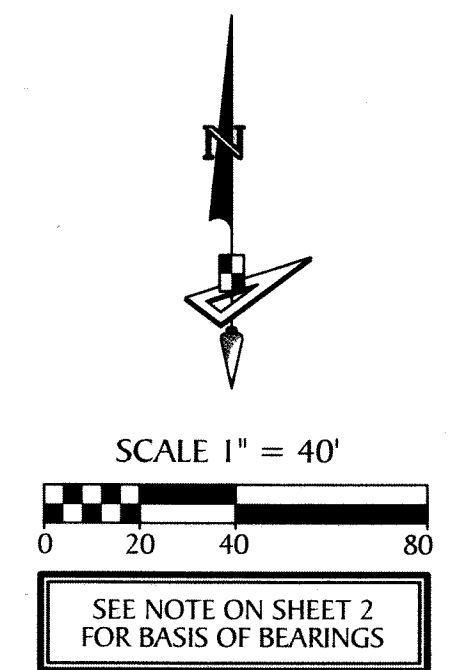

97

